

Polycom Deskphones

SoundPoint®

IP 320 ¹	IP 430 ¹	IP 560 ¹
IP 321 ¹	IP 450 ³	IP 650 ¹
IP 330 ¹	IP 550 ¹	IP 670 ²
IP 331 ¹		



SoundPoint IP 320 and IP 330 require 2.5mm to RJ-9 converter cable to connect to the headset port (sold separately).

- 1 Requires SIP application 3.1 or higher and BootROM 4.1.0 or later.
- 2 Requires SIP application 3.0.2 or higher and BootROM 4.1.0 or later.
- 3 Requires SIP application 3.1.0 Rev C or higher and BootROM 4.1.0 or later.

Please check plantronics.com for more phone options.

Savi Office

ORDER INFORMATION



Savi™ Office

Designed for seamless communication
Next generation of wireless headsets to maximize collaboration through multiple devices. Enterprise grade headset system providing excellent sound quality.

WO100
(Convertible headset system)



REMOTE CALL ANSWERING

Requires following EHS solution to automatically answer a call by pressing a button on the headset.

APP-50 (sold separately)



SET UP INFORMATION

For a complete set up list please refer to the user guide.

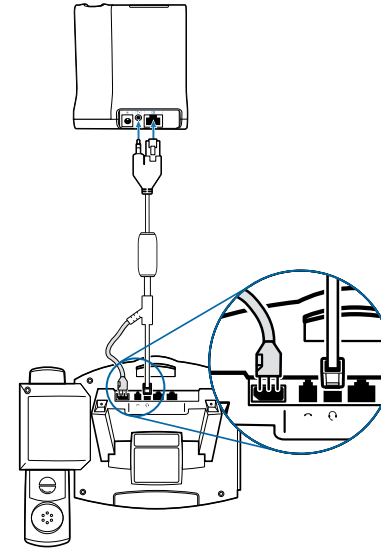

Set desk phone speaking volume to 2

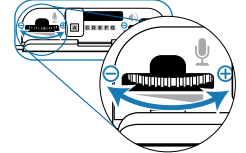

Configuration switch

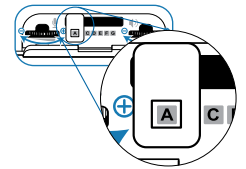

Set desk phone listening volume to 3

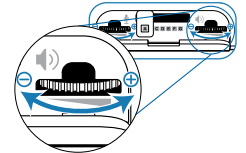

CS55/CS70N/Plantronics Voyager 510S/SupraPlus Wireless

ORDER INFORMATION

Plantronics Voyager® 510S System



Bluetooth



Office and mobile phone usage
Use one headset for calls both in and out of the office with a noise cancelling microphone. Share seamlessly between office phone and Bluetooth® mobile phone or smart phone.
Voyager 510S



CS70N™ Wireless

Stylish and discreet
Combining the excellent sound quality and range of DECT™ with the design edge of a mobile headset.

CS70N



CS55™ Wireless



Flexible, cost effective and convenient
Cost-effective wireless headset with great range and sound quality and a choice of wearing styles.
CS55



SupraPlus® Wireless

All-day wearing comfort
For intensive phone users—the ultimate comfort and sound quality—with the option of binaural style for noisy environments.

CS351N Monaural
CS361N Binaural



REMOTE CALL ANSWERING

Requires following EHS solution to automatically answer a call by pressing a button on the headset.

APP-5 (sold separately)



SET UP INFORMATION

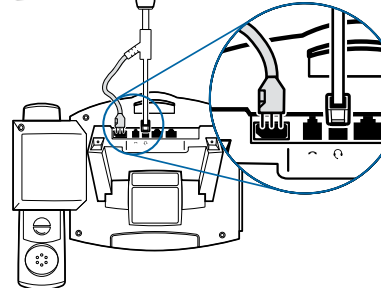
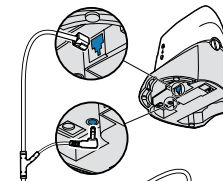

Set rotary switch to 1

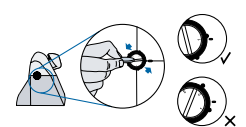

Set rear slide switch to 2

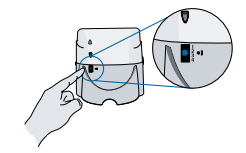

Set bottom slide switch to A

